



EVENLITE

LIFE SAFETY LIGHTING SOLUTIONS

RAZOR-3 SERIES

RZR3 DIE CAST ALUMINUM EXIT SIGN / FIXTURE

UNIVERSAL FACE CONVERSION

INSTALLATION AND OPERATING INSTRUCTIONS

IMPORTANT SAFEGUARDS

When using electrical equipment, basic safety precautions should always be followed including the following:

READ AND FOLLOW ALL SAFETY INSTRUCTIONS

1. DO NOT use outdoors.
2. DO NOT mount near gas or electric heaters.
3. Equipment should be mounted in locations and at heights where it will not be readily subject to tampering by unauthorized personnel.
4. The use of accessory equipment is not recommended by the manufacturer. Use of such equipment may cause an unsafe condition.
5. DO NOT use this equipment for other than intended use.
6. Conduct periodic visibility tests in accordance with the applicable installation code (such as NFPA 101).
7. Supply connections MUST be made inside the junction box.
8. Install using recommended junction box ONLY.
9. Servicing of this equipment should be performed by a qualified service personnel.
10. Install sign indoors only where not exposed to direct unfiltered sunlight, liquid spray or temperatures outside of the range of 10°C to 40°C.
11. Before installing unit, disconnect power at breaker panel.

SAVE THESE INSTRUCTIONS

CONSERVER LA FICHE D'INSTRUCTION

2575 Metropolitan Drive • Trevoise • PA 19053 U•S•A

Telephone: (215) 244-4204 • Fax: (215) 244-4208

Field selectable single or double sign conversion

Universal face contains the following items in the box that allows the conversion of a sign from a single face to a double face, canopy mounted, sign without requesting additional parts from the factory.

1. Single Face Sign
2. Legend Panel (front Panel)
3. Diffuser

1. Open enclosure and separate panels using a flat blade screw driver (as shown below).

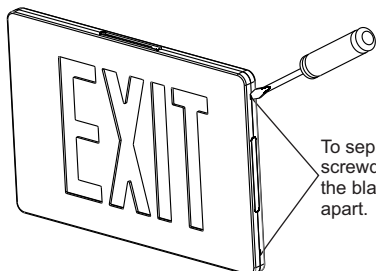

To separate the housing, insert a flat blade screwdriver into the 4 slots on the edge and rotate the blade gently so that the housings snaps apart. Repeat on all sides before pulling apart.

Figure 1: Opening the sign

2. Open the sign and remove the legend divider and the rear panel.

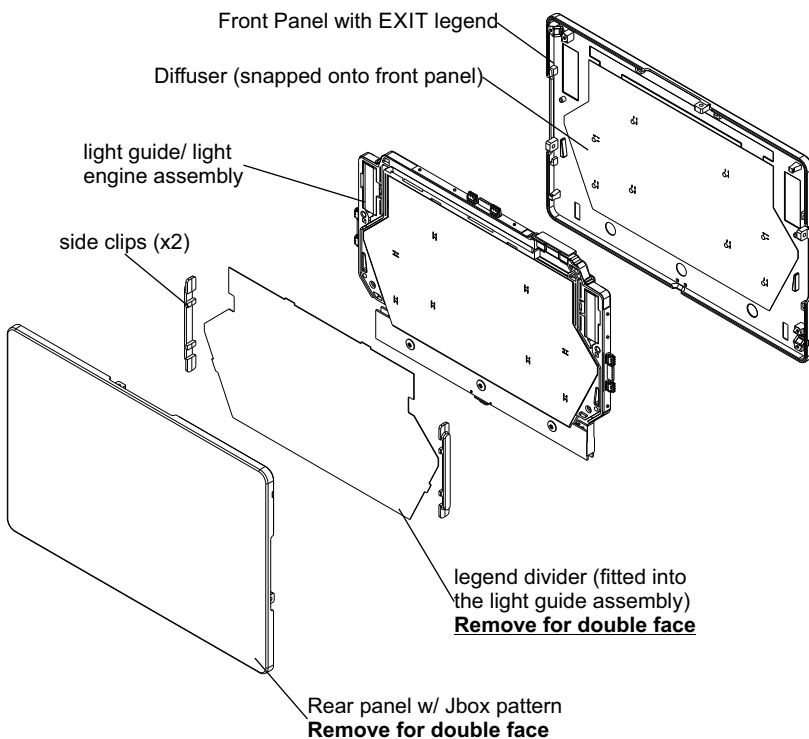

Figure 2: Remove single face components

3. Replace the rear panel with the front panel provided (with diffuser installed). Legend divider is not required for a double face sign.

Supplied preassembled

{ Front Panel with EXIT legend
Diffuser (snapped onto front panel)

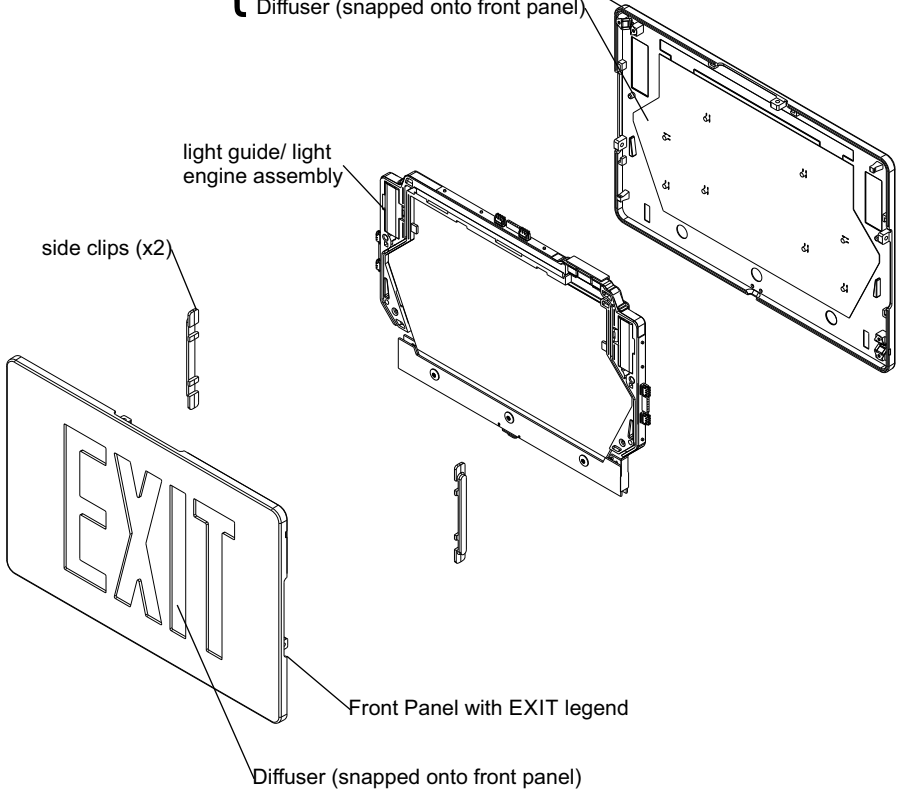

Figure 3: Add double face components

For various mounting options and wiring the sign, refer to RZR3 Product Manual - Z410139 for full details.